

# Standard Features

- Corian® Countertops
- Floating Cabinets
- Vessel Sinks with Hi-Rise Faucets
- In Counter Soap Dispensers
- Back Lit Shatterproof Mirrors
- Decorative Can Lighting
- Pedal Flush China Toilets
- Auto Flush China Urinal
- Designer Toilet Paper Holders
- 15" LCD TV's (2)
- Multi Disk CD/DVD Player with AM/FM Stereo
- Custom Wood Trim Package



Wells Fargo COG

[www.wellscargocog.com](http://www.wellscargocog.com)

(888) 574-4222

# Platinum Edition

At its heart, the Comfort Elite Platinum Edition is all about offering luxurious surroundings for discerning guests. A fusion of chic elegance and contemporary flair, each restroom is beautifully styled with upscale amenities including vessel sinks, Corian® countertops, stereo music and flat screen TV's. Even your most discriminating guests are sure to leave with a pleasant experience and a lasting impression. See the knowledgeable and experienced professionals at Wells Cargo COG for details.



## Comfort Elite™ Platinum Edition Floorplan: Model WC18

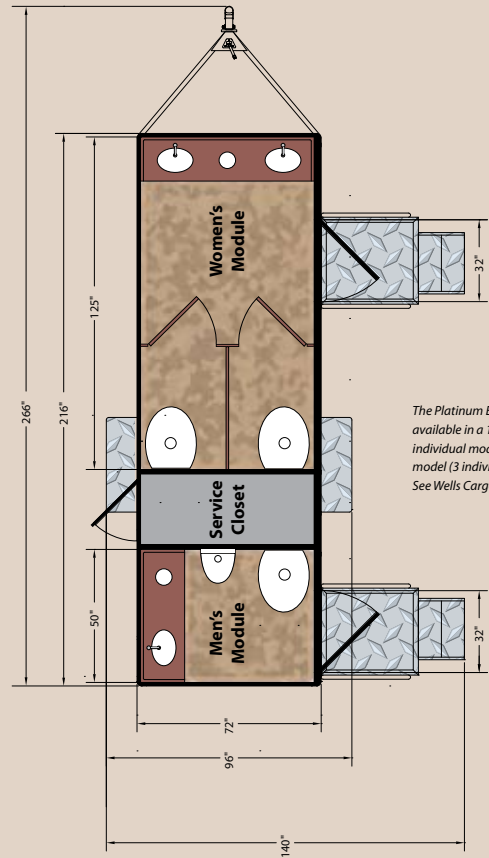

# Men's Module



- 38" Deep Aluminum Folding Platform with Steps (Powder Coated with Skid Resistant Material)
- Stainless Steel Handrails
- Radius Entry Doors with Hydraulic Door Closure
- 9,000 BTU A/C, 5,600 BTU Heat Strip and Wall Thermostat
- 465 Gallon Waste Holding Tank with 3" Ball Valve and 1" Wash Out
- LED Sensor for Monitoring Waste Holding Tank
- 110 Gallon Fresh Water Tank with 12 Volt Demand Pump
- BAL Stabilizer Jacks
- 5,000 lb. Drop Leg Jack
- Wells Cargo LED Safety Package
- D.O.T. Compliant Safety Chains
- 6-Year Wells Cargo Never Look Back Warranty